

bi+guardTM

science for animal care

Animal Rapid Test Catalogue



Accuracy / Simplicity / Reliability

Bioguard Corporation - An international company dedicated to companion animal disease diagnosis

Bioguard Corporation is a leading global enterprise developing and integrating companion and small animal diagnostic solutions to address present challenges and anticipate future needs. We offer inclusive rapid tests and medical solutions to veterinarians worldwide, transforming how diseases can be diagnosed and examined.

Our Services include:

- ☑ Advanced Laboratory based diagnostics solutions: covering molecular diagnostics (canine, feline and exotic), genetic test, microbial culture/antibiotics sensitivity test, clinical chemistry, immunoassays (endocrine and allergy test), and histopathology/cytology.
- ☑ Commercial diagnostic devices and products: Covering comprehensive rapid tests, immunofluorescence analyzer, real-time fluorescence quantitative PCR, etc.

From the beginning, improving our pet's lives has been the sole purpose of our business. We started as a reference laboratory, and it was Taiwan's first ISO/IEC17025 accredited testing laboratory. Soon after we expanded ourselves internationally with a branch office in Canada and an ISO/IEC17025 accredited testing laboratory in Shanghai.

Various infectious diseases in animals, such as tick-borne, respiratory, diarrheal, etc., are major problems for veterinarians to deal with. We created *in vitro* rapid tests to detect the respective disease-causing agents accurately. With the help of our tests, veterinarians are identifying and diagnosing such diseases, making faster and more accurate decisions in their practices. We manufacture our diagnostic products in ISO13485:2016 accredited manufacturing facilities in Taiwan under strict quality assurance systems. Altogether, they are part of our fast-growing lab technology services.

Considering the future needs of veterinarians and using innovations and new ideas, we continue to upgrade our portfolio. Bioguard is going to launch its diagnostics device series starting with an immunofluorescence analyzer (VScan Analyzer) for detecting health biomarkers and an advanced real-time fluorescence-based quantitative PCR that is the gold standard for specific detection & quantification of nucleic acid targets.

Living our purpose of creating a healthier future with no limits to healthcare, we continue to bring innovative new solutions to the market and dedicate ourselves to solving the extreme challenges in pet healthcare that animal clinics and hospitals face today.

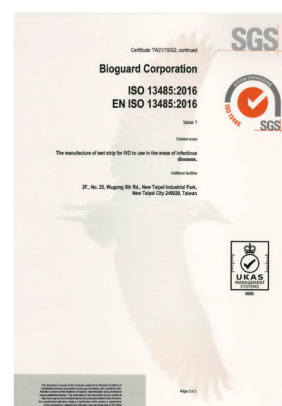

Providing professional, dedicated services and high-quality products to veterinarians is **bi+guard** most important core value.

at **bi+guard**

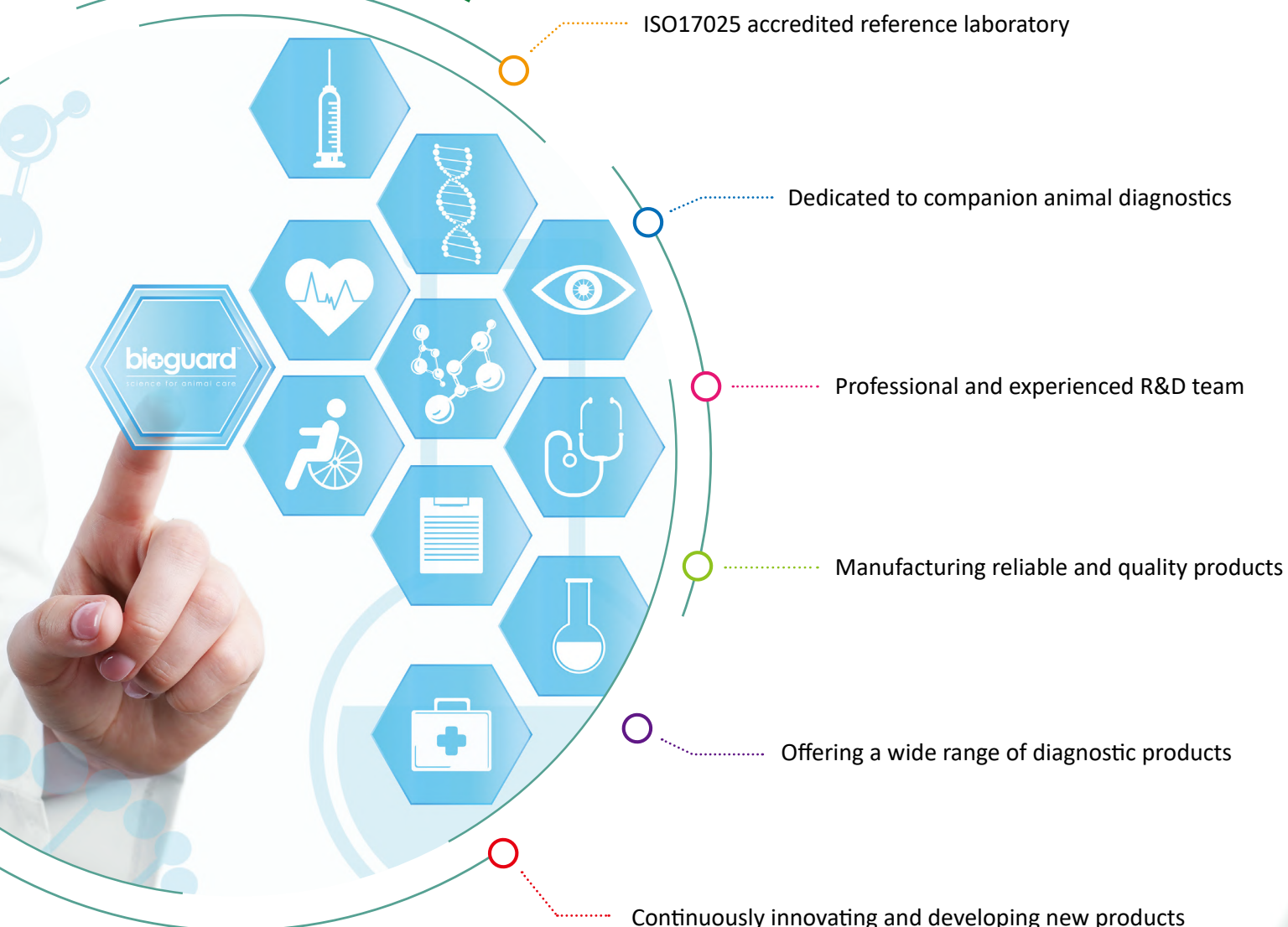

TABLE OF CONTENTS



Canine

CPV Ag Test	05
Canine Parvovirus Antigen Test	
CDV Ag Test	06
Canine Distemper Virus Antigen Test	
CHW Ag Test	07
Canine Heartworm Antigen Test	
E. canis Ab Test	08
Ehrlichia canis Antibody Test	
Anaplasma Ab Test	09
Anaplasma Antibody Test	
Leishmania Ab Test	10
Leishmania Antibody Test	
Canine Babesia gibsoni Ab Test	11
Canine Babesia gibsoni Antibody Test	
Canine Babesia spp. Ab Test	12
Canine Babesia spp. Antibody Test	
Giardia Ag Test	13
Giardia Antigen Test	
CPV Ag /CCV Ag Combo Test	14
CPV Ag /CCV Ag Combo Test	
ANA Ab/E.canis Ab Combo Test	15
Anaplasma Ab/E.canis Ab Combo Test	
VLabs 3DX	16
CPV Ag /CCV Ag /Giardia Ag Test	
VLabs 3RX	17
CDV Ag /CAV Ag /CIV Ag Test	
VLabs 4X	18
E. canis Ab /Anaplasma Ab/ Lyme Ab/ CHW Ag Test	
VLabs 4BX	19
E. canis Ab /Anaplasma Ab/ B. gibsoni Ab/ CHW Ag Test	
VLabs 4BX Plus	20
E. canis Ab /Anaplasma Ab/ Babesia Ab/ CHW Ag Combo Test	
VLabs 4LX	21
E. canis Ab /Anaplasma Ab/ Leishmania Ab/ CHW Ag Test	



Feline

FPV Ag Test	22
Feline Parvovirus Antigen Test	
Toxoplasma IgM/IgG Ab Test	23
Toxoplasma IgM / IgG Antibody Test	
FCoV Ab Test	24
Feline Coronavirus Antibody Test	
FCoV Ag Test	25
Feline Coronavirus Antigen Test	
FCV Ag /FHV Ag Combo Test	26
FCV Ag /FHV Ag Combo Test	
FeLV Ag/FIV Ab Combo Test	27
FeLV Ag/FIV Ab Combo Test	
Feline 3X	28
FeLV Ag/FIV Ab/FCoV Ab Test	
Feline 3DX	29
FPV Ag/FCoV Ag/Giardia Ag Test	



Exotics

Salmonella Ag Test	30
Salmonella spp. Antigen Test	
Candida albicans Antigen Test	31
Candida albicans Antigen Test	
Giardia Antigen Test	32
Giardia Antigen Test	



Other Products

Peritonitis	33
Peritonitis Detection Kit	
Feline Blood Typing Kit	34
Ordering Information	35
User Guide	38



CPV Ag Test

Canine Parvovirus Antigen Test

Canine parvovirus (CPV) is a highly contagious virus that causes acute gastrointestinal symptoms in dogs aged 6-20 weeks and other animals. CPV is transmitted through direct or indirect contact with feces containing the virus. Clinical symptoms include depression, loss of appetite, abdominal pain, fever, vomiting, and severe diarrhea (blood in stool).

➤ PRODUCT INTRODUCTION

Methodology	Immunochromatographic assay
Target	Canine parvovirus antigen
Specifications	Sensitivity: 95.74% vs PCR Specificity: 100% vs PCR



➤ KIT COMPONENTS

COMPONENTS	5 TESTS/KIT	10 TESTS/KIT
CPV Ag test device	5	10
Disposable dropper	5	10
Assay buffer	5	10
Sterile swab	5	10
Instruction	1	1



Specimen Feces



Animal Canine



Measurement time 5-10 minutes

➤ TEST PROCEDURE AND INTERPRETATION

Not enough **Good** **Too much**

Collect dog's feces with the swab, and make the swab well absorbed by the feces. **Collect feces as shown in the picture. Excessive fecal amount may induce a false positive result and slow the flow on the test strip.**

Unscrew the cap of provided assay buffer tube. Insert and mix the specimen swab into the tube. Stand for 1 min after thoroughly mixed.

Take the upper layer of mixture for testing **<Do not take the sediment from lower layer to prevent obstruction in the test strip.>**

Gradually drip 4 drops (100µL) of specimen into the sample well using disposable dropper. Interpret the result in 5-10 minutes.

Positive **Negative** **Invalid**

⊗ **False positive** : recent vaccination

⊗ **False negative** : very early stages of infection (not enough viral shedding), or due to decreased viral shedding in later stages of infection

➤ ORDERING INFORMATION

Product Name	Cat. No.	Packaging	Shelf Life
CPV Ag test	RC01-0	5 Tests/Kit	24 months
	RC01-1	10 Tests/Kit	



CDV Ag Test

Canine Distemper Virus Antigen Test

Canine Distemper virus (CDV) is a highly contagious disease in the young and unvaccinated domestic and feral dogs. Transmitted through droplet infection, shared food & drinking water, and contaminated environment, CDV affects the respiratory tract, gastrointestinal tract, and nervous system. Symptoms including fever, conjunctivitis, eye & nose discharge, dyspnea, cough, vomiting, and diarrhea. The most common symptoms are hyperkeratosis of the foot pads and nose of the feet. Therefore, CDV infection is also known as "hard pad disease." Severe cases of CDV infections can even cause death.

➤ PRODUCT INTRODUCTION

Methodology	Immunochromatographic assay
Target	Canine distemper virus antigen
Specifications	Sensitivity: 100% vs. RT-PCR Specificity: 98.08% vs. RT-PCR



➤ KIT COMPONENTS

COMPONENTS	5 TESTS/KIT	10 TESTS/KIT
CDV Ag test device	5	10
Disposable dropper	5	10
Assay buffer	5	10
Sterile swab	5	10
Instruction	1	1



Specimen
Ocular/nasal discharge



Animal
Canine



Measurement time
5-10 minutes

➤ TEST PROCEDURE AND INTERPRETATION

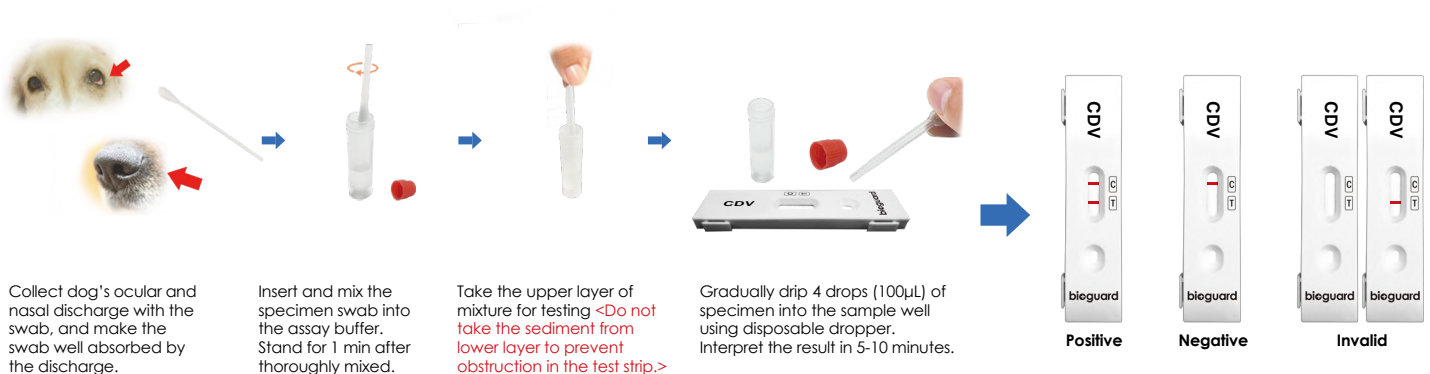

⊙False positive : recent vaccination

⊙False negative : very early stages of infection (not enough viral shedding)

➤ ORDERING INFORMATION

Product Name	Cat. No.	Packaging	Shelf Life
CDV Ag test	RC03-0	5 Tests/Kit	24 months
	RC03-1	10 Tests/Kit	



CHW Ag Test

Canine Heartworm Antigen Test

Canine heartworm disease is a vector-borne disease transmitted by mosquitoes and caused by *Dirofilaria immitis* (also known as canine heartworm) that infects dogs and cats. Adult heartworms will parasitize the left ventricle and pulmonary artery of dogs. Once the artery is clogged with worms, it will cause circulatory obstruction resulting in exercise intolerance, wheezing, and decreased appetite. Severe symptoms may lead to heart failure and death.

➤ PRODUCT INTRODUCTION

Methodology	Immunochromatographic assay
Target	<i>Dirofilaria immitis</i> (mature female heartworm) antigen
Specifications	Sensitivity: 99.03% vs. Necropsy Specificity: 100% vs. Necropsy



➤ KIT COMPONENTS

COMPONENTS	5 TESTS/KIT	10 TESTS/KIT
CHW Ag test device	5	10
Disposable dropper	5	10
EDTA blood collection tube	5	10
Assay buffer	1	1
Instruction	1	1



Specimen
Whole blood/
serum/plasma



Animal
Canine



Measurement time
5-10 minutes

➤ TEST PROCEDURE AND INTERPRETATION



⊙ **False positive** : very rare

⊙ **False negative** : very low numbers of parasites, immature females, or males only. A negative antigen test result does not mean there is no heartworm infection.

➤ ORDERING INFORMATION

Product Name	Cat. No.	Packaging	Shelf Life
CHW Ag test	RC06-0	5 test/Box	24 months
	RC06-1	10 test/Box	



E. canis Ab Test

Ehrlichia canis Antibody Test

Ehrlichia canis (*E. canis*) is a rickettsial species transmitted to dogs by ticks. It parasitizes monocytes and macrophages and causes blood cell destruction. Symptoms include depression, lethargy, loss of appetite, weight loss, fever, mucosal pallor, lymph node lesions, hepatosplenomegaly, vomiting, uveitis, edema of the extremities, and failure of other organs. Symptoms become severe if the host is co-infected with *E. canis* and other blood parasites (e.g., Canine *Babesia*).

➤ PRODUCT INTRODUCTION

Methodology	Immunochromatographic assay
Target	<i>E. canis</i> antibody
Specifications	Sensitivity: 93.55% vs. PCR Specificity: 96.86% vs. PCR



➤ KIT COMPONENTS

COMPONENTS	5 TESTS/KIT	10 TESTS/KIT
E. canis Ab test device	5	10
Disposable dropper	5	10
EDTA blood collection tube	5	10
Assay buffer	1	1
Instruction	1	1



Specimen
Whole blood/
serum/plasma



Animal
Canine



Measurement time
5-10 minutes

➤ TEST PROCEDURE AND INTERPRETATION



⊗ **False positive** : previous infection

⊗ **False negative** : early stages of infection (not enough or no antibodies produced)

➤ ORDERING INFORMATION

Product Name	Cat. No.	Packaging	Shelf Life
E. canis Ab test	RC07-0	5 Tests/Kit	24 months
	RC07-1	10 Tests/Kit	



Anaplasma Ab Test

Anaplasma Antibody Test

Anaplasma phagocytophilum (*A. phagocytophilum*) and *Anaplasma platys* (*A. platys*) are rickettsial pathogens transmitted to dogs by ticks. They primarily infect neutrophils and platelets, causing blood cell destruction. Clinical signs include vomiting, diarrhea, coughing, and shortness of breath.

➤ PRODUCT INTRODUCTION

Methodology	Immunochromatographic assay
Target	<i>A. phagocytophilum</i> and <i>A. platys</i> antibody
Specifications	Sensitivity: 94.59% vs. PCR Specificity: 98.98% vs. PCR



➤ KIT COMPONENTS

COMPONENTS	5 TESTS/KIT	10 TESTS/KIT
Anaplasma Ab test device	5	10
Disposable dropper	5	10
EDTA blood collection tube	5	10
Assay buffer	1	1
Instruction	1	1



Specimen
Whole blood/
serum/plasma



Animal
Canine



Measurement time
5-10 minutes

➤ TEST PROCEDURE AND INTERPRETATION



⊗ **False positive** : previous infection

⊗ **False negative** : early stages of infection (not enough or no antibodies produced)

➤ ORDERING INFORMATION

Product Name	Cat. No.	Packaging	Shelf Life
Anaplasma Ab test	RC08-0	5 Tests/Kit	24 months
	RC08-1	10 Tests/Kit	



Leishmania Ab Test

Leishmania Antibody Test

Leishmaniasis is a protozoan disease caused by *Leishmania infantum* and is transmitted by the bite of infected female phlebotomine sandflies. The course of infection may be different in each dog. Symptoms include skin lesions, eye abnormalities, epistaxis, weight loss, exercise intolerance, and lethargy. Without proper treatment, the disease can go from spontaneous to acute onset of death. Treatment is not curative, so relapses are common after stopping the medication.

➤ PRODUCT INTRODUCTION

Methodology	Immunochromatographic assay
Target	Leishmania antibody
Specifications	Sensitivity: 95.83% vs. ELISA Specificity: 93.07% vs. ELISA



➤ KIT COMPONENTS

COMPONENTS	5 TESTS/KIT	10 TESTS/KIT
LSH Ab test device	5	10
Disposable dropper	5	10
EDTA blood collection tube	5	10
Assay buffer	1	1
Instruction	1	1



Specimen
Whole blood/
serum/plasma



Animal
Canine



Measurement time
5-10 minutes

➤ TEST PROCEDURE AND INTERPRETATION



⊙ **False positive** : previous infection

⊙ **False negative** : early stages of infection (not enough or no antibodies produced)

➤ ORDERING INFORMATION

Product Name	Cat. No.	Packaging	Shelf Life
Leishmania Ab test	RC10-0	5 Tests/Kit	24 months
	RC10-1	10 Tests/Kit	



Canine Babesia gibsoni Ab Test

Canine Babesia gibsoni Antibody Test

Babesia gibsoni is a blood parasite transmitted by ticks. It lives in red blood cells and triggers an immune response that causes red blood cell destruction, resulting in anemia, weakness, jaundice, fever, and dark urine. *Babesia gibsoni* (small Babesia) is generally more challenging to treat than other forms (large Babesia). The dog remains infected even when a clinical cure is achieved. Frequent recurrences of the disease occur after treatment.

➤ PRODUCT INTRODUCTION

Methodology	Immunochromatographic assay
Target	<i>B. gibsoni</i> antibody
Specifications	Sensitivity: 92.13 % vs. PCR Specificity: 94.59 % vs. PCR



➤ KIT COMPONENTS

COMPONENTS	5 TESTS/KIT	10 TESTS/KIT
<i>B. gibsoni</i> Ab test device	5	10
Disposable dropper	5	10
EDTA blood collection tube	5	10
Assay buffer	1	1
Instruction	1	1



Specimen
Whole blood/
serum/plasma



Animal
Canine



Measurement time
5-10 minutes

➤ TEST PROCEDURE AND INTERPRETATION



⊙ **False positive** : previous infection

⊙ **False negative** : early stages of infection (not enough or no antibodies produced)

➤ ORDERING INFORMATION

Product Name	Cat. No.	Packaging	Shelf Life
<i>B. gibsoni</i> Ab test	RC11-0	5 Tests/Kit	24 months
	RC11-1	10 Tests/Kit	



Canine Babesia spp. Ab Test

Canine Babesia spp. Antibody Test

Babesia is a blood parasite with more than 100 identified species. Dogs are mainly infected by *Babesia canis* and *Babesia gibsoni*, which are transmitted by ticks. It can also be transmitted by the bites of flies or the blood of infected animals and rarely through vertical transmission. The disease is widespread, mainly in temperate climate regions on earth.

➤ PRODUCT INTRODUCTION

Methodology	Immunochromatographic assay
Target	Babesia spp. antibody
Specifications	Sensitivity: 95.05% vs. PCR Specificity: 92.24% vs. PCR



➤ KIT COMPONENTS

COMPONENTS	5 TESTS/KIT	10 TESTS/KIT
Babesia Ab test device	5	10
Disposable dropper	5	10
EDTA blood collection tube	5	10
Assay buffer	1	1
Instruction	1	1



Specimen
Whole blood/
serum/plasma



Animal
Canine



Measurement time
5-10 minutes

➤ TEST PROCEDURE AND INTERPRETATION



⊗ **False positive** : previous infection

⊗ **False negative** : early stages of infection (not enough or no antibodies produced)

➤ ORDERING INFORMATION

Product Name	Cat. No.	Packaging	Shelf Life
Babesia Ab test	RC12-0	5 Tests/Kit	24 months
	RC12-1	10 Tests/Kit	



Giardia Ag Test

Giardia Antigen Test

Giardia duodenalis (*G. duodenalis*), also known as *G. intestinalis* and *G. lamblia*, is a protozoal parasite that infects the gastrointestinal tract of dogs and cats, causing acute and chronic diarrhea and sometimes malabsorption and vomiting. There are many cases of long-term diarrhea from *G. duodenalis* infection. Examining stool samples under a microscope can identify only 60% of infections. In addition to fecal microscopic examination, rapid antigen detection tests can detect Giardia antigens in feces if the dogs and cats show chronic diarrhea.

▶ PRODUCT INTRODUCTION

Methodology	Immunochromatographic assay
Target	Giardia antigen
Specifications	Sensitivity: 100% vs. Microscopy Result Specificity: 95.24% vs. Microscopy Result



▶ KIT COMPONENTS

COMPONENTS	5 TESTS/KIT	10 TESTS/KIT
GIA Ag test device	5	10
Disposable dropper	5	10
Assay buffer	5	10
Sterile swab	5	10
Instruction	1	1



**Specimen
Feces**



**Animal
Canine/Feline**



**Measurement time
5-10 minutes**

▶ TEST PROCEDURE AND INTERPRETATION



Collect dog's feces with the swab, and make the swab well absorbed by the feces. **Collect feces as shown in the picture. Excessive fecal amount may induce a false positive result and slow the flow on the test strip.**



Unscrew the cap of provided assay buffer tube. Insert and mix the specimen swab into the tube. Stand for 1 min after thoroughly mixed.



Take the upper layer of mixture for testing **<Do not take the sediment from lower layer to prevent obstruction in the test strip.>**



Gradually drip 4 drops (100µL) of specimen into the sample well using disposable dropper. Interpret the result in 5-10 minutes.



Positive



Negative



Invalid

▶ ORDERING INFORMATION

Product Name	Cat. No.	Packaging	Shelf Life
Giardia Ag test	RC13-0	5 Tests/Kit	24 months
	RC13-1	10 Tests/Kit	



CPV Ag /CCV Ag Combo Test

CPV Ag /CCV Ag Combo Test

Canine parvovirus (CPV) and canine coronavirus (CCV) infections are highly contagious viral diseases that cause gastrointestinal illness in dogs. They also cause similar symptoms, including vomiting, anorexia, fever, depression, diarrhea, and watery diarrhea containing mucus and blood. When infection occurs concurrently, the mortality rate may be as high as 90%.

➤ PRODUCT INTRODUCTION

Methodology	Immunochromatographic assay
Target	Canine parvovirus antigen/ Canine coronavirus antigen
Specifications	<p>CPV: Sensitivity: 95.74% vs PCR Specificity: 100% vs PCR</p> <p>CCV: Sensitivity: 93.10% vs Nested PCR Specificity: 97.52% vs Nested PCR</p>



➤ KIT COMPONENTS

COMPONENTS	5 TESTS/KIT	10 TESTS/KIT
CPV Ag/CCV Ag test device	5	10
Disposable dropper	5	10
Assay buffer	5	10
Sterile swab	5	10
Instruction	1	1



**Specimen
Feces**



**Animal
Canine**



**Measurement time
5-10 minutes**

➤ TEST PROCEDURE AND INTERPRETATION

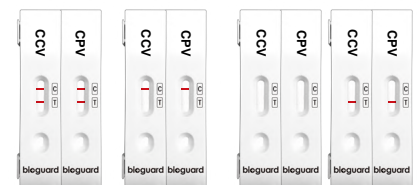

Collect dog's feces with the swab, and make the swab well absorbed by the feces. **Collect feces as shown in the picture. Excessive fecal amount may induce a false positive result and slow the flow on the test strip.**

Unscrew the cap of provided assay buffer tube. Insert and mix the specimen swab into the tube. Stand for 1 min after thoroughly mixed.

Take the upper layer of mixture for testing **<Do not take the sediment from lower layer to prevent obstruction in the test strip.>**

Gradually drip 4 drops (100µL) of specimen into the sample well using disposable dropper. Interpret the result in 5-10 minutes.

Positive Negative Invalid

⊗ **False positive** : recent vaccination

⊗ **False negative** : very early stages of infection (not enough viral shedding), or due to decreased viral shedding in later stages

➤ ORDERING INFORMATION

Product Name	Cat. No.	Packaging	Shelf Life
CPV Ag/CCV Ag combo test	RC14-0	5 Tests/Kit	24 months
	RC14-1	10 Tests/Kit	



ANA Ab/E.canis Ab Combo Test

Anaplasma Ab/E.canis Ab Combo Test

Anaplasmosis and Ehrlichiosis are tick-borne diseases caused by obligate intracellular bacteria, including *Ehrlichia canis*, *Anaplasma phagocytophilum*, and *Anaplasma platys*. Clinical symptoms include depression, lethargy, loss of appetite, weight loss, fever, mucosal pallor, lymph node lesions, hepatosplenomegaly, vomiting, uveitis, edema of the extremities, and failure of other organs. The clinical symptoms will be more severe if co-infected with other blood parasites (e.g., Babesia).

➤ PRODUCT INTRODUCTION

Methodology	Immunochromatographic assay
Target	E. canis antibody/ A. phagocytophilum & A. platys antibody
Specifications	Anaplasma: Sensitivity: 94.59% vs. PCR Specificity: 98.98% vs. PCR E. canis: Sensitivity: 93.55% vs. PCR Specificity: 96.86% vs. PCR



➤ KIT COMPONENTS

COMPONENTS	5 TESTS/KIT	10 TESTS/KIT
Anaplasma Ab/E. canis Ab test device	5	10
Disposable dropper	5	10
EDTA blood collection tube	5	10
Assay buffer	1	1
Instruction	1	1



Specimen
Whole blood/
serum/plasma



Animal
Canine



Measurement time
5-10 minutes

➤ TEST PROCEDURE AND INTERPRETATION

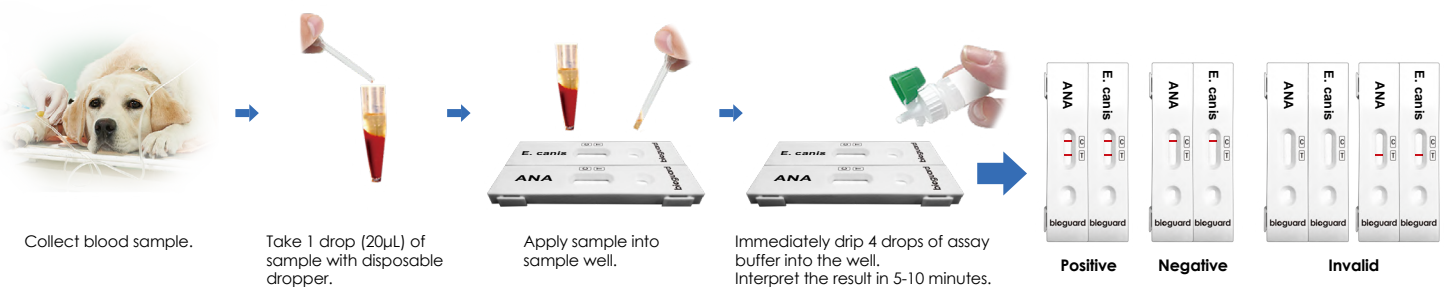

⊗ **False positive** : previous infection

⊗ **False negative** : early stages of infection (Ab titer is low)

➤ ORDERING INFORMATION

Product Name	Cat. No.	Packaging	Shelf Life
Anaplasma Ab/E.canis Ab Combo Test	RC15-0	5 Tests/Kit	24 months
	RC15-1	10 Tests/Kit	



VLabs 3DX

CPV Ag /CCV Ag /Giardia Ag Test

Canine parvovirus (CPV) and Canine coronavirus (CCV) are both highly contagious viral diseases that cause gastrointestinal illness in dogs. Giardia is also a protozoal parasite that infects the gastrointestinal tract of dogs. Common clinical symptoms for these diseases include diarrhea and vomiting.

➤ PRODUCT INTRODUCTION

Methodology	Immunochromatographic assay
Target	Canine parvovirus antigen / Canine coronavirus antigen / Giardia antigen
Specifications	CPV: Sensitivity: 95.74% vs PCR Specificity: 100% vs PCR CCV: Sensitivity: 93.10% vs Nested PCR Specificity: 97.52% vs Nested PCR Giardia: Sensitivity: 100% vs. Microscopy Result Specificity: 95.24% vs. Microscopy Result



➤ KIT COMPONENTS

COMPONENTS	5 TESTS/KIT	10 TESTS/KIT
VLabs 3DX test device	5	10
Disposable dropper	5	10
Assay buffer	5	10
Sterile swab	5	10
Instruction	1	1



Specimen
Feces



Animal
Canine



Measurement time
5-10 minutes

➤ TEST PROCEDURE AND INTERPRETATION

Not enough Good Too much

Collect dog's feces with the swab, and make the swab well absorbed by the feces. **Collect feces as shown in the picture. Excessive fecal amount may induce a false positive result and slow the flow on the test strip.**

Unscrew the cap of provided assay buffer tube. Insert and mix the specimen swab into the tube. Stand for 1 min after thoroughly mixed.

Take the upper layer of mixture for testing **<Do not take the sediment from lower layer to prevent obstruction in the test strip.>**

Gradually drip 4 drops (100µL) of specimen into the sample well using disposable dropper. Interpret the result in 5-10 minutes.

Positive **Negative** **Invalid**

➤ ORDERING INFORMATION

Product Name	Cat. No.	Packaging	Shelf Life
VLabs 3DX	RC16-0	5 Tests/Kit	24 months
	RC16-1	10 Tests/Kit	



VLabs 3RX

CDV Ag /CAV Ag /CIV Ag Test

Canine infectious respiratory disease (CIRD) is an acute, highly contagious disease caused by various pathogens, including canine distemper virus, canine adenovirus, and canine influenza virus. Other pathogens, such as Bordetella bronchiseptica and canine herpes virus, are also possible agents of CIRD. CIRD is commonly found in young dogs and dog gathering places such as shelters or kennels. Common clinical signs include coughing, sneezing, and discharge from the nose and eyes.

▶ PRODUCT INTRODUCTION

Methodology	Immunochromatographic assay
Target	Canine distemper virus antigen/ Canine adenovirus antigen/ Canine influenza virus antigen
Specifications	<p>CDV: Sensitivity: 100% vs. RT-PCR Specificity: 98.08% vs. RT-PCR</p> <p>CAV: Sensitivity: 88.88% vs. PCR Specificity: 95.35% vs. PCR</p> <p>CIV: Sensitivity: 90.00% vs. RT-PCR Specificity: 100% vs. RT-PCR</p>



▶ KIT COMPONENTS

COMPONENTS	5 TESTS/KIT	10 TESTS/KIT
VLabs 3RX test device	5	10
Disposable dropper	5	10
Assay buffer	5	10
Sterile swab	5	10
Instruction	1	1



Specimen
Ocular/nasal
discharge



Animal
Canine



Measurement time
5-10 minutes

▶ TEST PROCEDURE AND INTERPRETATION

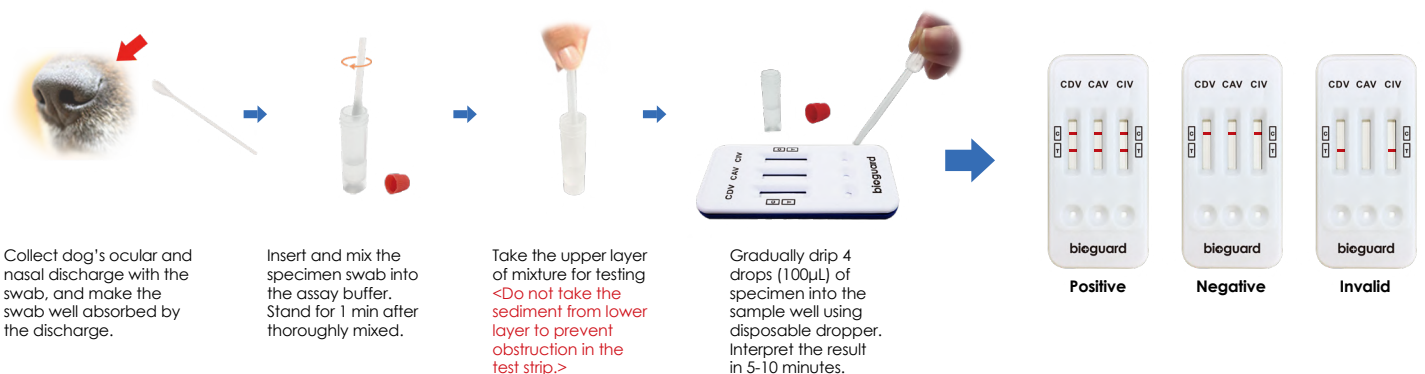

▶ ORDERING INFORMATION

Product Name	Cat. No.	Packaging	Shelf Life
VLabs 3RX	RC17-0	5 Tests/Kit	24 months
	RC17-1	10 Tests/Kit	



VLabs 4X

E. canis Ab /Anaplasma Ab/ Lyme Ab/ CHW Ag Test

Ehrlichiosis (*Ehrlichia canis*), anaplasmosis (*Anaplasma phagocytophilum* and *Anaplasma platys*), and Lyme disease are common tick-borne diseases in dogs. Heartworm disease (*Dirofilaria immitis*) is another common infectious disease in dogs transmitted by mosquitoes. Rapid and accurate diagnosis and prompt treatment of infected animals are essential to controlling these diseases.

▶ PRODUCT INTRODUCTION

Methodology	Immunochromatographic assay
Target	E. canis antibody/ A. phagocytophilum & A. platys antibody / Borrelia burgdorferi antibody/ Dirofilaria immitis (mature female heartworm) antigen
Specifications	Borrelia burgdorferi: Sensitivity: 95.00% vs. PCR Specificity: 96.67% vs. PCR Anaplasma: Sensitivity: 94.59% vs. PCR Specificity: 98.98% vs. PCR E. canis: Sensitivity: 93.55% vs. PCR Specificity: 96.86% vs. PCR CHW: Sensitivity: 99.03% vs. Necropsy Specificity: 100% vs. Necropsy



Specimen
Whole blood/
serum/plasma



Animal
Canine



Measurement time
5-10 minutes

▶ KIT COMPONENTS

COMPONENTS	5 TESTS/KIT	10 TESTS/KIT
VLabs 4X test device	5	10
Disposable dropper	5	10
EDTA blood collection tube	5	10
Assay buffer	1	1
Instruction	1	1

▶ TEST PROCEDURE AND INTERPRETATION

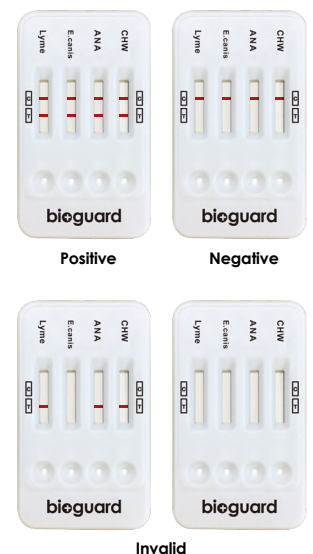
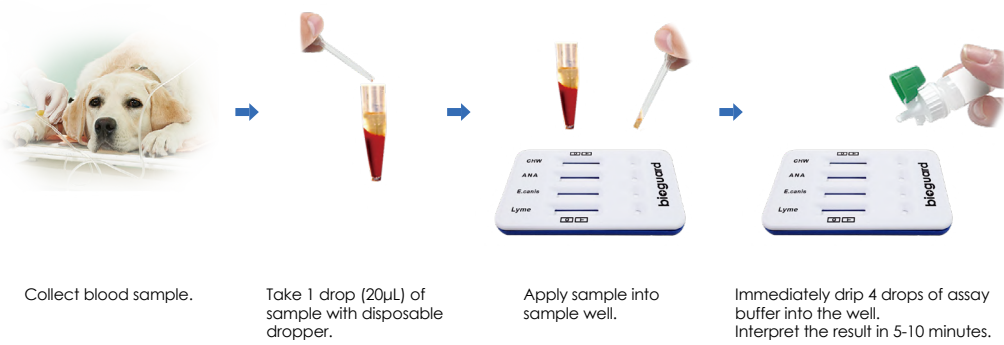

▶ ORDERING INFORMATION

Product Name	Cat. No.	Packaging	Shelf Life
VLabs 4X	RC18-0	5 Tests/Kit	24 months
	RC18-1	10 Tests/Kit	



V Labs 4BX

E. canis Ab /Anaplasma Ab/ B. gibsoni Ab/ CHW Ag Test

Ehrlichiosis (*Ehrlichia canis*), anaplasmosis (*Anaplasma phagocytophilum* and *Anaplasma platys*), and Babesiosis (*Babesia gibsoni*) are common tick-borne diseases in dogs. Heartworm disease (*Dirofilaria immitis*) is another common infectious disease in dogs transmitted by mosquitoes. Rapid and accurate diagnosis and prompt treatment of infected animals are essential to controlling these diseases.

▶ PRODUCT INTRODUCTION

Methodology	Immunochromatographic assay
Target	E. canis antibody/ A. phagocytophilum & A. platys antibody / Babesia gibsoni antibody/ Dirofilaria immitis (mature female heartworm) antigen Anaplasma:
Specifications	Sensitivity: 94.59% vs. PCR Specificity: 98.98% vs. PCR
	E. canis: Sensitivity: 93.55% vs. PCR Specificity: 96.86% vs. PCR
	CHW: Sensitivity: 99.03% vs. Necropsy Specificity: 100% vs. Necropsy
	Babesia gibsoni: Sensitivity: 92.13 % vs. PCR Specificity: 94.59 % vs. PCR



Specimen
Whole blood/
serum/plasma



Animal
Canine



Measurement time
5-10 minutes

▶ KIT COMPONENTS

COMPONENTS	5 TESTS/KIT	10 TESTS/KIT
V Labs 4BX test device	5	10
Disposable dropper	5	10
EDTA blood collection tube	5	10
Assay buffer	1	1
Instruction	1	1

▶ TEST PROCEDURE AND INTERPRETATION

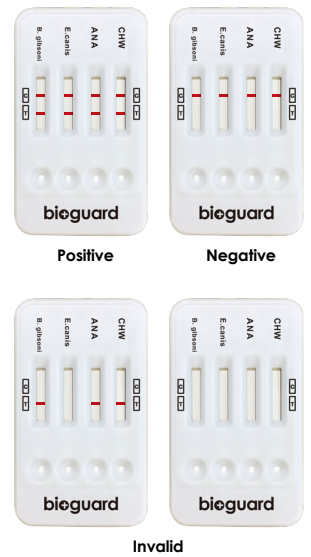
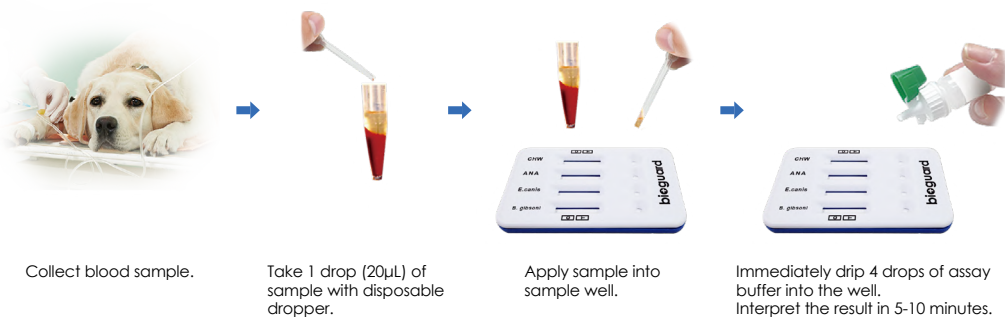

▶ ORDERING INFORMATION

Product Name	Cat. No.	Packaging	Shelf Life
V Labs 4BX	RC19-0	5 Tests/Kit	24 months
	RC19-1	10 Tests/Kit	



VLabs 4BX Plus

E. canis Ab /Anaplasma Ab/ Babesia Ab/ CHW Ag Combo Test

Ehrlichiosis (*Ehrlichia canis*), anaplasmosis (*Anaplasma phagocytophilum* and *Anaplasma platys*), and Babesiosis (*Babesia* spp.) are common tick-borne diseases in dogs. Heartworm disease (*Dirofilaria immitis*) is another common infectious disease in dogs transmitted by mosquitoes. Rapid and accurate diagnosis and prompt treatment of infected animals are essential to controlling these diseases.

▶ PRODUCT INTRODUCTION

Methodology	Immunochromatographic assay
Target	E. canis antibody/ A. phagocytophilum & A. platys antibody / Babesia spp. antibody/ Dirofilaria immitis (mature female heartworm) antigen
Specifications	Anaplasma: Sensitivity: 94.59% vs. PCR Specificity: 98.98% vs. PCR E. canis: Sensitivity: 93.55% vs. PCR Specificity: 96.86% vs. PCR CHW: Sensitivity: 99.03% vs. Necropsy Specificity: 100% vs. Necropsy Babesia spp.: Sensitivity: 95.05% vs. PCR Specificity: 92.24 % vs. PCR



Specimen
Whole blood/
serum/plasma



Animal
Canine



Measurement time
5-10 minutes

▶ KIT COMPONENTS

COMPONENTS	5 TESTS/KIT	10 TESTS/KIT
VLabs 4BX Plus test device	5	10
Disposable dropper	5	10
EDTA blood collection tube	5	10
Assay buffer	1	1
Instruction	1	1

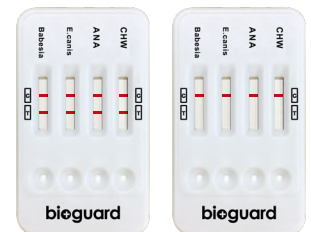

Positive

Negative

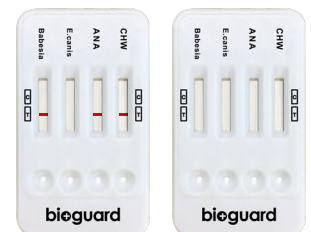

Invalid

▶ TEST PROCEDURE AND INTERPRETATION

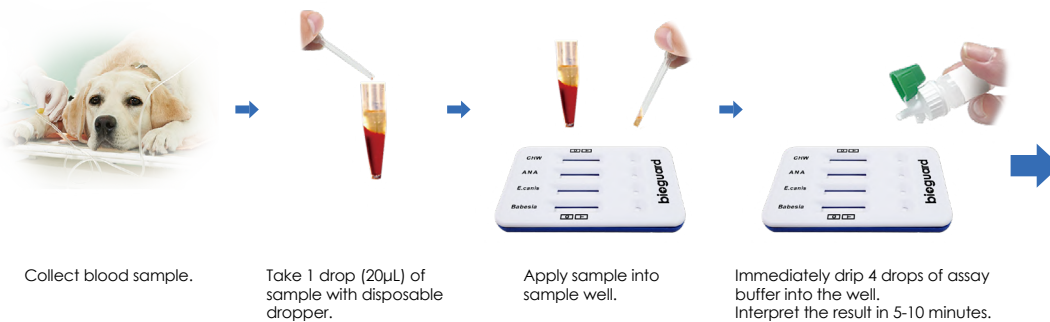

▶ ORDERING INFORMATION

Product Name	Cat. No.	Packaging	Shelf Life
VLabs 4BX Plus	RC20-0	5 Tests/Kit	24 months
	RC20-1	10 Tests/Kit	



VLabs 4LX

E. canis Ab /Anaplasma Ab/ Leishmania Ab/ CHW Ag Test

Ehrlichiosis (*Ehrlichia canis*) and anaplasmosis (*Anaplasma phagocytophilum* and *Anaplasma platys*) are common tick-borne diseases in dogs. Other common vector borne diseases in dogs include heartworm disease (*Dirofilaria immitis*), transmitted by mosquitoes, and Leishmaniasis (*Leishmania infantum*), transmitted by female phlebotomine sandflies. Rapid and accurate diagnosis and prompt treatment of infected animals are essential to controlling these diseases.

▶ PRODUCT INTRODUCTION

Methodology	Immunochromatographic assay
Target	E. canis antibody/ A. phagocytophilum & A. platys antibody/ Leishmania antibody/ Dirofilaria immitis (mature female heartworm) antigen
Specifications	Anaplasma: Sensitivity: 94.59% vs. PCR Specificity: 98.98% vs. PCR E. canis: Sensitivity: 93.55% vs. PCR Specificity: 96.86% vs. PCR CHW: Sensitivity: 99.03% vs. Necropsy Specificity: 100% vs. Necropsy Leishmania: Sensitivity: 95.83 % vs. ELISA Specificity: 93.07% vs. ELISA



Specimen
Whole blood/
serum/plasma



Animal
Canine



Measurement time
5-10 minutes

▶ KIT COMPONENTS

COMPONENTS	5 TESTS/KIT	10 TESTS/KIT
VLabs 4LX test device	5	10
Disposable dropper	5	10
EDTA blood collection tube	5	10
Assay buffer	1	1
Instruction	1	1

▶ TEST PROCEDURE AND INTERPRETATION

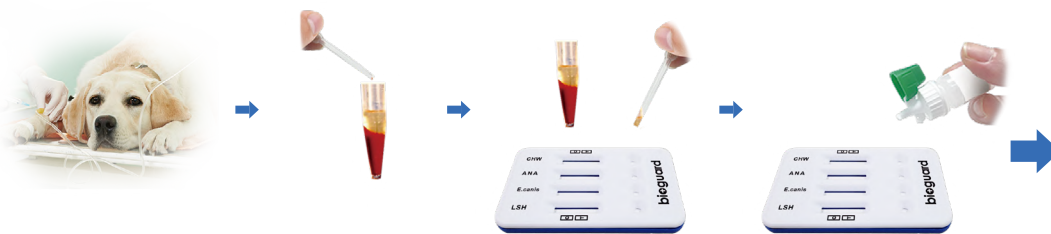

Collect blood sample.

Take 1 drop (20µL) of sample with disposable dropper.

Apply sample into sample well.

Immediately drip 4 drops of assay buffer into the well. Interpret the result in 5-10 minutes.

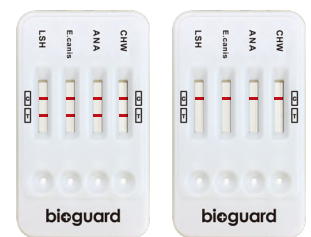

Positive

Negative

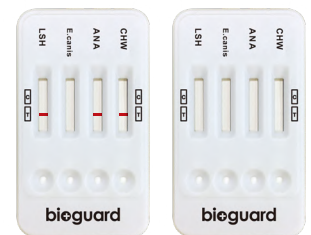

Invalid

▶ ORDERING INFORMATION

Product Name	Cat. No.	Packaging	Shelf Life
VLabs 4LX	RC21-0	5 Tests/Kit	24 months
	RC21-1	10 Tests/Kit	



FPV Ag Test

Feline Parvovirus Antigen Test

Feline panleukopenia, also called feline distemper, is caused by feline parvovirus (FPV). The virus attacks the body's intestinal mucosal cells, lymphoid tissue, and bone marrow, causing enteritis and panleukopenia. FPV is transmitted through direct contact with the virus in vomit, feces, and other excretions. It can also be transmitted vertically from the mother to the fetus through the placenta. Kittens within 10-12 weeks old are susceptible to FPV. Clinical Symptoms include fever, tiredness, decreased appetite, vomiting, diarrhea, and hypothermia. The mortality rate is 50%-80%.

➤ PRODUCT INTRODUCTION

Methodology	Immunochromatographic assay
Target	Feline parvovirus antigen
Specifications	Sensitivity: 92.54 % vs. PCR Specificity: 97.09 % vs. PCR



➤ KIT COMPONENTS

COMPONENTS	5 TESTS/KIT	10 TESTS/KIT
FPV Ag test device	5	10
Disposable dropper	5	10
Assay buffer	5	10
Sterile swab	5	10
Instruction	1	1

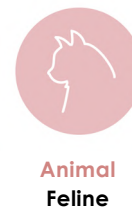

➤ TEST PROCEDURE AND INTERPRETATION

Not enough Good Too much

Collect cat's feces with the swab, and make the swab well absorbed by the feces. Collect feces as shown in the picture. Excessive fecal amount may induce a false positive result and slow the flow on the test strip.

Unscrew the cap of provided assay buffer tube. Insert and mix the specimen swab into the tube. Stand for 1 min after thoroughly mixed.

Take the upper layer of mixture for testing <Do not take the sediment from lower layer to prevent obstruction in the test strip.>

Gradually drip 4 drops (100µL) of specimen into the sample well using disposable dropper. Interpret the result in 5-10 minutes.

Positive **Negative** **Invalid**

⊙ **False positive** : recent vaccination

⊙ **False negative** : very early stages of infection (not enough viral shedding), or due to decreased viral shedding in later stages of infection

➤ ORDERING INFORMATION

Product Name	Cat. No.	Packaging	Shelf Life
FPV Ag Test	RF03-0	5 Tests/Kit	24 months
	RF03-1	10 Tests/Kit	



Toxoplasma IgM/IgG Ab Test

Toxoplasma IgM / IgG Antibody Test

Toxoplasma gondii (*T. gondii*) is one of the most widely spread parasites in the world. It can infect most warm-blooded animals, including pets, livestock, birds, and humans. However, the only known definitive hosts for *T. gondii* are members of the family Felidae. Infection of *T. gondii* is widespread in cats, but clinical disease is rare. Up to 50% of cats (especially free-roaming cats) have antibodies against *T. gondii*. IgM antibodies will increase rapidly within a week of infection and maintain the peak level for over three months. IgG antibodies indicate the cat has been infected with *Toxoplasma* for a while.

➤ PRODUCT INTRODUCTION

Methodology	Immunochromatographic assay
Target	Toxoplasma IgM / IgG antibody
Specifications	Sensitivity: 92.59 % vs. ELISA Specificity: 94.37 % vs. ELISA



➤ KIT COMPONENTS

COMPONENTS	5 TESTS/KIT	10 TESTS/KIT
Toxo Ab test device	5	10
Disposable dropper	5	10
EDTA blood collection tube	5	10
Assay buffer	1	1
Instruction	1	1



Specimen
Whole blood/
serum/plasma



Animal
Feline



Measurement time
5-10 minutes

➤ TEST PROCEDURE AND INTERPRETATION

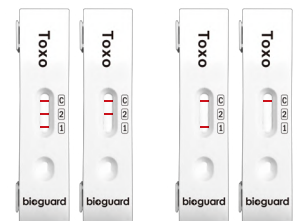
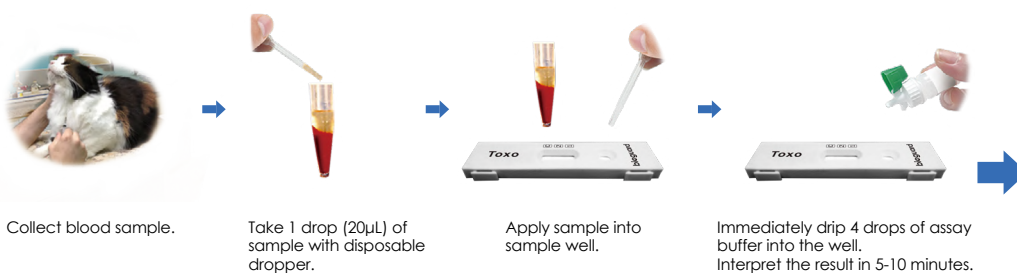

Positive

Negative

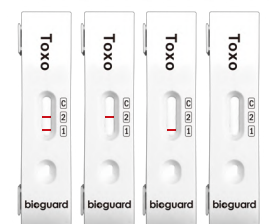

Invalid

*T1=IgM, T2=IgG

- ⊙IgM Ab : It means recent infection. IgM is serologically detected 1 week after infection and their levels rise until peaking after 1-3 months.
- ⊙IgG Ab : IgG appears after 2 weeks of infection and peaks at 3 months. It remains at a plateau level for 6 months and then slowly decreases.

➤ ORDERING INFORMATION

Product Name	Cat. No.	Packaging	Shelf Life
Toxoplasma IgM/IgG Ab Test	RF04-0	5 Tests/Kit	24 months
	RF04-1	10 Tests/Kit	



FCoV Ab Test

Feline Coronavirus Antibody Test

Feline coronavirus (FCoV) is an RNA virus. FCoV exists in two biological types: Feline Infectious Peritonitis Virus (FIPV) and Feline Enteric Coronavirus (FECV). FCoV is commonly present in felines, especially cats raised in large groups. According to previous studies, 75-100% of farm cats and 25% of domestic cats tested positive for coronavirus.

➤ PRODUCT INTRODUCTION

Methodology	Immunochromatographic assay
Target	Feline coronavirus antibody
Specifications	Sensitivity: 88.57 % vs. Western blot Specificity: 94.23 % vs. Western blot



➤ KIT COMPONENTS

COMPONENTS	5 TESTS/KIT	10 TESTS/KIT
FCoV Ab test device	5	10
Disposable dropper	5	10
EDTA blood collection tube	5	10
Assay buffer	5	10
Instruction	1	1



Specimen
Serum/plasma/
pleural effusion/
ascites



Animal
Feline



Measurement time
5-10 minutes

➤ TEST PROCEDURE AND INTERPRETATION

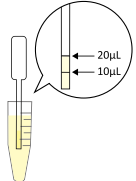

Take 1 drop (20µL) of sample (serum, plasma, or pleural/abdominal effusion) with disposable dropper.

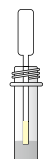

Add sample into assay buffer.

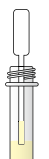

Mix thoroughly.

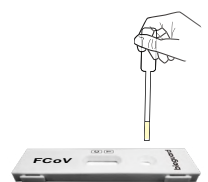

Immediately drip 4 drops of mixture into sample well. Interpret the result in 5-10 minutes.

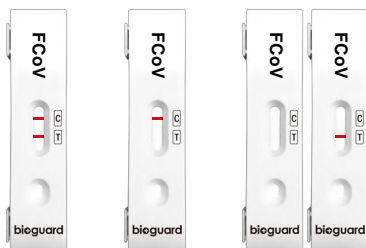

Positive **Negative** **Invalid**

⊙False positive : previous infection

⊙False negative : high viral loads sequestering antibodies in antigen- antibody complexes

➤ ORDERING INFORMATION

Product Name	Cat. No.	Packaging	Shelf Life
FCoV Ab Test	RF05-0	5 Tests/Kit	24 months
	RF05-1	10 Tests/Kit	



FCoV Ag Test

Feline Coronavirus Antigen Test

Feline coronavirus (FCoV) is an RNA virus. FCoV exists in two biological types: Feline Infectious Peritonitis Virus (FIPV) and Feline Enteric Coronavirus (FECV). FCoV is commonly present in felines, especially cats raised in large groups. According to previous studies, 75-100% of farm cats and 25% of domestic cats tested positive for coronavirus.

➤ PRODUCT INTRODUCTION

Methodology	Immunochromatographic assay
Target	Feline coronavirus antigen
Specifications	Sensitivity: 96.67 % vs. RT-PCR Specificity: 100 % vs. RT-PCR



➤ KIT COMPONENTS

COMPONENTS	5 TESTS/KIT	10 TESTS/KIT
FCoV Ag test device	5	10
Disposable dropper	5	10
Assay buffer	5	10
Sterile swab	5	10
Instruction	1	1



**Specimen
Feces**



**Animal
Feline**



**Measurement time
5-10 minutes**

➤ TEST PROCEDURE AND INTERPRETATION



Collect cat's feces with the swab, and make the swab well absorbed by the feces. Collect feces as shown in the picture. Excessive fecal amount may induce a false positive result and slow the flow of the test strip.

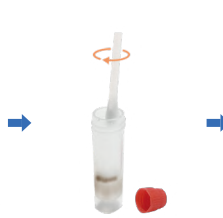

Unscrew the cap of provided assay buffer tube. Insert and mix the specimen swab into the tube. Stand for 1 min after thoroughly mixed.

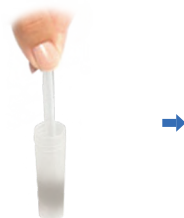

Take the upper layer of mixture for testing <Do not take the sediment from lower layer to prevent obstruction in the test strip.>



Gradually drip 4 drops (100µL) of specimen into the sample well using disposable dropper. Interpret the result in 5-10 minutes.



Positive



Negative



Invalid

⊗ **False positive** : uncommon

⊗ **False negative** : very early stages of infection (not enough viral shedding), or due to decreased viral shedding in later stages

➤ ORDERING INFORMATION

Product Name	Cat. No.	Packaging	Shelf Life
FCoV Ag Test	RF06-0	5 Tests/Kit	24 months
	RF06-1	10 Tests/Kit	



FCV Ag /FHV Ag Combo Test

FCV Ag /FHV Ag Combo Test

Feline Calicivirus (FCV) and Feline herpes virus (FHV) are the two primary causes of upper respiratory tract disease in cats, especially in kittens. Without prompt treatment, they may cause severe diseases with multiple organ damage or even death in newborn kittens.

▶ PRODUCT INTRODUCTION

Methodology	Immunochromatographic assay
Target	Feline calicivirus antigen/ Feline herpes virus antigen
Specifications	FCV: Sensitivity: 97.00 % vs. RT-PCR Specificity: 100 % vs. RT-PCR FHV: Sensitivity: 97.00 % vs. RT-PCR Specificity: 100 % vs. RT-PCR



▶ KIT COMPONENTS

COMPONENTS	5 TESTS/KIT	10 TESTS/KIT
FCV Ag / FHV Ag test device	5	10
Disposable dropper	5	10
Assay buffer	5	10
Sterile swab	5	10
Instruction	1	1



Specimen
Ocular/nasal
discharge



Animal
Feline



Measurement time
5-10 minutes

▶ TEST PROCEDURE AND INTERPRETATION

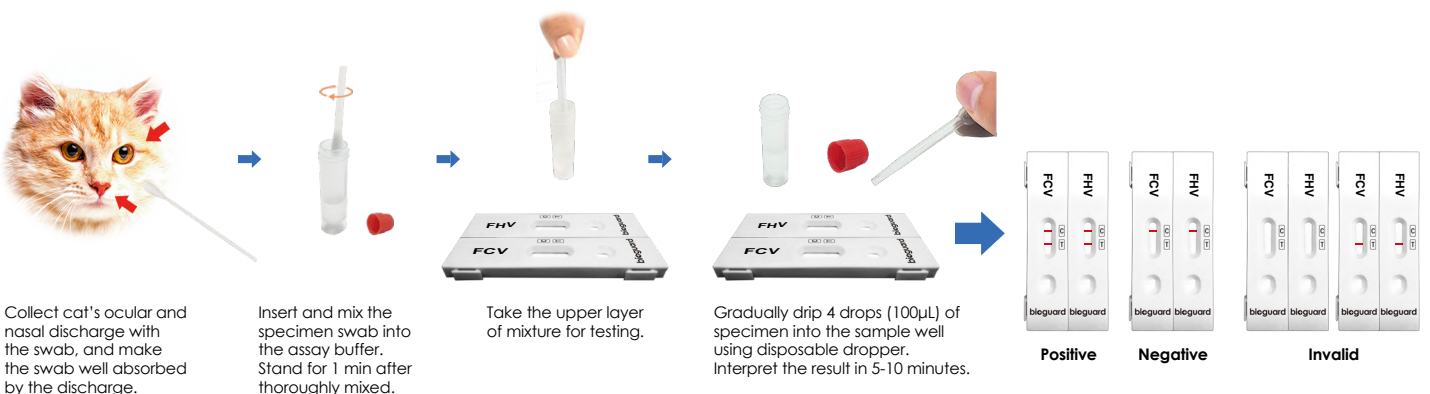

▶ ORDERING INFORMATION

Product Name	Cat. No.	Packaging	Shelf Life
FCV Ag/ FHV Ag Combo Test	RF10-0	5 Tests/Kit	24 months
	RF10-1	10 Tests/Kit	



FeLV Ag/FIV Ab Combo Test

FeLV Ag/FIV Ab Combo Test

Feline leukemia virus (FeLV) and Feline immunodeficiency virus (FIV) are retroviruses affecting cats worldwide. Infection of FeLV or FIV can cause a variety of clinical signs and impact the quality of life and life span in cats. The American Association of Feline Practitioners (AAFP) recommends that all cats be tested for these viral infections at the proper intervals based on the cat's risk assessments.

➤ PRODUCT INTRODUCTION

Methodology	Immunochromatographic assay
Target	Feline leukemia virus antigen / Feline immunodeficiency virus antibody
Specifications	FIV: Sensitivity: 97.50 % vs. Western blot Specificity: 96.67 % vs. Western blot FeLV: Sensitivity: 98.04 % vs. RT-PCR Specificity: 98.70 % vs. RT-PCR



➤ KIT COMPONENTS

COMPONENTS	5 TESTS/KIT	10 TESTS/KIT
FeLV Ag/FIV Ab test device	5	10
Disposable dropper	5	10
EDTA blood collection tube	5	10
FeLV assay buffer	1	1
FIV assay buffer	1	1
Instruction	1	1



Specimen
Whole blood/
serum/plasma



Animal
Feline



Measurement time
5-10 minutes

➤ TEST PROCEDURE AND INTERPRETATION

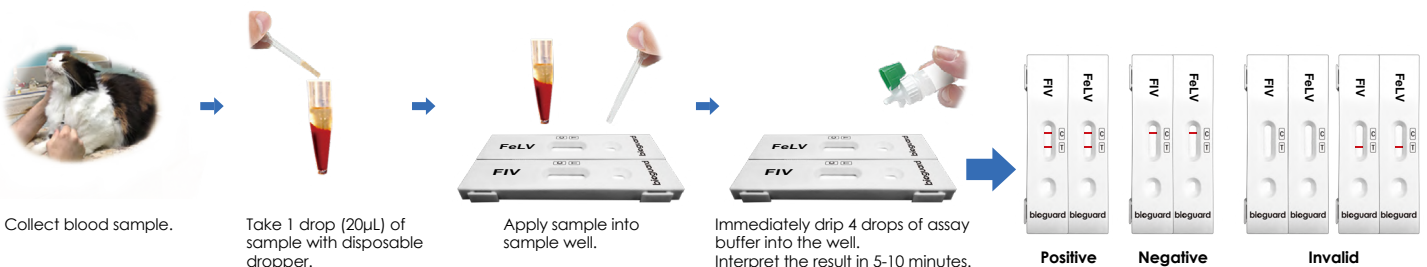

➤ ORDERING INFORMATION

Product Name	Cat. No.	Packaging	Shelf Life
FeLV Ag/FIV Ab Combo Test	RF11-0	5 Tests/Kit	24 months
	RF11-1	10 Tests/Kit	



Feline 3X

FeLV Ag/FIV Ab/FCoV Ab Test

Feline leukemia virus (FeLV) and Feline immunodeficiency virus (FIV) belong to retroviruses affecting cats worldwide. Feline coronavirus (FCoV) is also a widespread viral infection in cats. All three viruses can cause severe disease in cats.

➤ PRODUCT INTRODUCTION

Methodology	Immunochromatographic assay
Target	Feline leukemia virus antigen / Feline immunodeficiency virus antibody / Feline coronavirus antibody
Specifications	FIV: Sensitivity: 97.50 % vs. Western blot Specificity: 96.67 % vs. Western blot FeLV: Sensitivity: 98.04 % vs. RT-PCR Specificity: 98.70 % vs. RT-PCR FCoV: Sensitivity: 88.57 % vs. Western blot Specificity: 94.23 % vs. Western blot



Specimen
Whole blood / serum / plasma (FeLV / FIV)
Whole blood / serum / plasma / pleural effusion / abdominal effusion (FCoV)

Animal
Feline

Measurement time
5-10 minutes

➤ KIT COMPONENTS

COMPONENTS	5 TESTS/KIT	10 TESTS/KIT
Feline 3X test device	5	10
Disposable dropper	5	10
EDTA blood collection tube	5	10
FeLV assay buffer	1	1
FIV assay buffer	1	1
FCoV assay buffer	5	10
Instruction	1	1

➤ TEST PROCEDURE AND INTERPRETATION

FeLV Ag/FIV Ab:

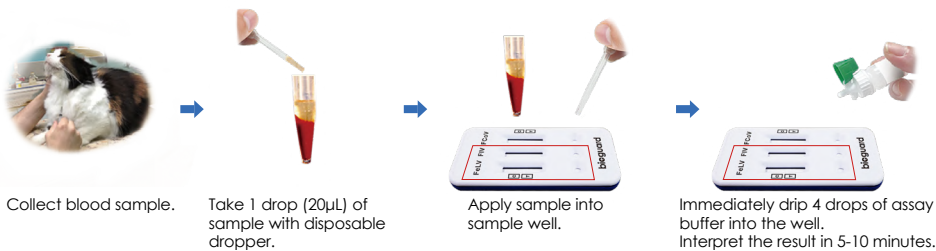

FCoV Ab:

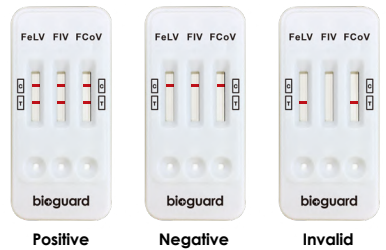
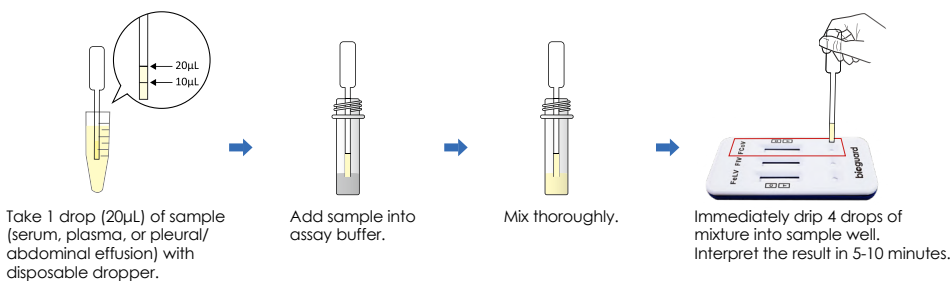

➤ ORDERING INFORMATION

Product Name	Cat. No.	Packaging	Shelf Life
Feline 3X Test	RF12-0	5 Tests/Kit	24 months
	RF12-1	10 Tests/Kit	



Feline 3DX

FPV Ag/FCoV Ag/Giardia Ag Test

Feline parvovirus, Feline coronavirus, and Giardia are common pathogens responsible for cat diarrhea. The treatments for the three diseases are different. Therefore, these three diseases should be considered for differential diagnosis in cats with diarrhea to provide effective treatment.

➤ PRODUCT INTRODUCTION

Methodology	Immunochromatographic assay
Target	Feline parvovirus antigen/ Feline coronavirus antigen/ Giardia antigen
Specifications	<p>FPV: Sensitivity: 92.54 % vs. PCR Specificity: 97.09 % vs. PCR</p> <p>FCoV: Sensitivity: 96.67 % vs. RT-PCR Specificity: 100 % vs. RT-PCR</p> <p>Giardia: Sensitivity: 100% vs. Microscopy Result Specificity: 95.24% vs. Microscopy Result</p>



Specimen
Feces



Animal
Feline



Measurement time
5-10 minutes

➤ KIT COMPONENTS

COMPONENTS	5 TESTS/KIT	10 TESTS/KIT
Feline 3DX test device	5	10
Disposable dropper	5	10
Assay buffer	5	10
Sterile swab	5	10
Instruction	1	1

➤ TEST PROCEDURE AND INTERPRETATION



Collect cat's feces with the swab, and make the swab well absorbed by the feces. Collect feces as shown in the picture. Excessive fecal amount may induce a false positive result and slow the flow of the test strip.



Unscrew the cap of provided assay buffer tube. Insert and mix the specimen swab into the tube. Stand for 1 min after thoroughly mixed.



Take the upper layer of mixture for testing <Do not take the sediment from lower layer to prevent obstruction in the test strip.>



Gradually drip 4 drops (100µL) of specimen into the sample well using disposable dropper. Interpret the result in 5-10 minutes.



Positive



Negative

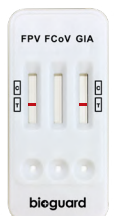

Invalid

➤ ORDERING INFORMATION

Product Name	Cat. No.	Packaging	Shelf Life
Feline 3DX Test	RF13-0	5 Tests/Kit	24 months
	RF13-1	10 Tests/Kit	



Salmonella Ag Test

Salmonella spp. Antigen Test

Salmonella can infect all birds, especially chickens, turkeys, and pheasants. It mainly infects chicks under three weeks old or chick embryos. Salmonella can cause indigestion, sticky green foam droppings with a foul odor, poor growth, weight loss, joint inflammation and swelling, drooping wings or inability to stand, and lameness. All symptoms may result in increased mortality of chicks. Adult birds usually show no symptoms, but it may cause a decrease in egg production.

PRODUCT INTRODUCTION

Methodology	Immunochromatographic assay
Target	Salmonella spp. antigen
Specifications	Sensitivity: 95.05% vs. PCR Specificity: 99.00% vs. PCR



KIT COMPONENTS

COMPONENTS	5 TESTS/KIT	10 TESTS/KIT
Salmonella Ag test device	5	10
Disposable dropper	5	10
Assay buffer	5	10
Sterile swab	5	10
Instruction	1	1



Specimen
Feces



Animal
Avian



Measurement time
5-10 minutes

TEST PROCEDURE AND INTERPRETATION

Not enough **good** **Too much**

Collect bird's feces with the swab, and make the swab well absorbed by the feces. **Collect feces as shown in the picture. Excessive fecal amount may induce a false positive result and slow the flow on the test strip.**

Unscrew the cap of provided assay buffer tube. Insert and mix the specimen swab into the tube. Stand for 1 min after thoroughly mixed.

Take the upper layer of mixture for testing **<Do not take the sediment from lower layer to prevent obstruction in the test strip.>**

Gradually drip 4 drops (100µL) of specimen into the sample well using disposable dropper. Interpret the result in 5-10 minutes.

Positive **Negative** **Invalid**

ORDERING INFORMATION

Product Name	Cat. No.	Packaging	Shelf Life
Salmonella Ag test	RE01-0	5 Tests/Kit	24 months
	RE01-1	10 Tests/Kit	



Candida albicans Antigen Test

Candida albicans Antigen Test

Candida albicans is a yeast that causes opportunistic infections. Secondary infections often occurs if the bird is immunocompromised. *Candida albicans* will cause sour crop or crop infection in most birds and mammals. It is transmitted through adult birds feeding young birds, contaminated environment or water, and artificial feeding. Common clinical symptoms include lethargy, fluffy feathers, loss of appetite, and delayed emptying of the crop of birds.

➤ PRODUCT INTRODUCTION

Methodology	Immunochromatographic assay
Target	<i>Candida albicans</i> antigen
Specifications	Sensitivity: 92.30 % vs. Other rapid test Specificity: 98.61 % vs. Other rapid test



➤ KIT COMPONENTS

COMPONENTS	5 TESTS/KIT	10 TESTS/KIT
Candida albicans Ag test device	5	10
Disposable dropper	5	10
Assay buffer	5	10
Sterile swab	5	10
Instruction	1	1



Specimen
Feces/Oral swab



Animal
Avian



Measurement time
5-10 minutes

➤ TEST PROCEDURE AND INTERPRETATION

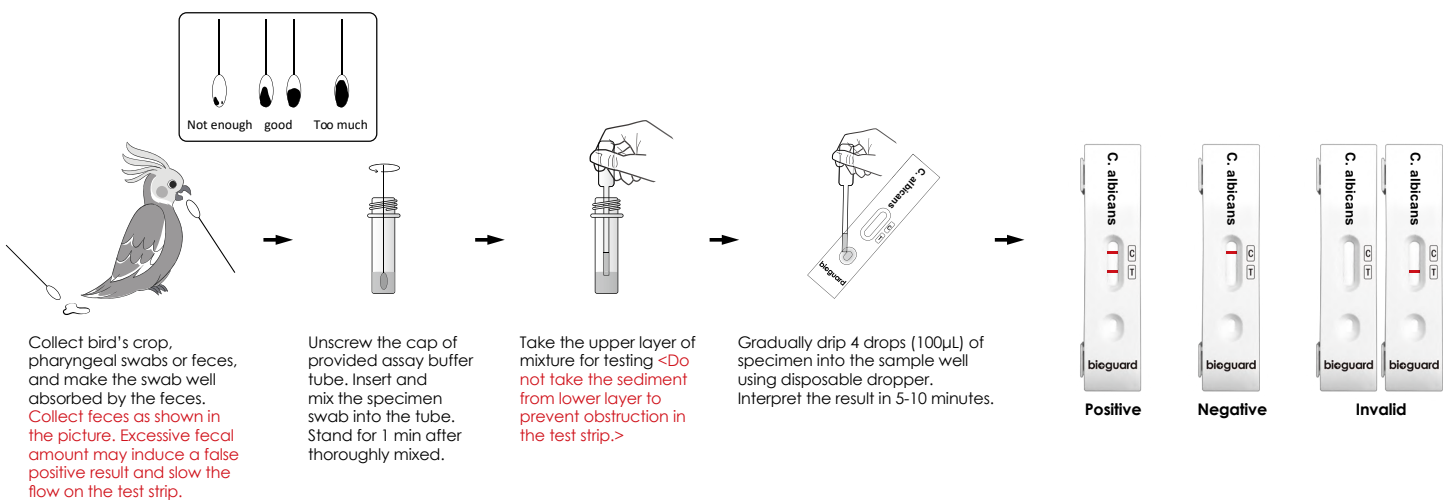

➤ ORDERING INFORMATION

Product Name	Cat. No.	Packaging	Shelf Life
Candida albicans Ag test	RE02-0	5 Tests/Kit	24 months
	RE02-1	10 Tests/Kit	



Giardia Antigen Test

Giardia Antigen Test

Giardia lamblia is a protozoan parasite that mainly infects the crop and duodenum of birds. It can cause weight loss, feather plucking, and diarrhea or feces containing undigested feed.

➤ PRODUCT INTRODUCTION

Methodology	Immunochromatographic assay
Target	Giardia antigen test
Specifications	Sensitivity: 100% vs. Microscopy Result Specificity: 95.24% vs. Microscopy Result



➤ KIT COMPONENTS

COMPONENTS	5 TESTS/KIT	10 TESTS/KIT
Giardia Ag test device	5	10
Disposable dropper	5	10
Assay buffer	5	10
Sterile swab	5	10
Instruction	1	1



Specimen Feces



Animal Avian



Measurement time 5-10 minutes

➤ TEST PROCEDURE AND INTERPRETATION

Not enough good Too much

Collect bird's feces with the swab, and make the swab well absorbed by the feces. **Collect feces as shown in the picture. Excessive fecal amount may induce a false positive result and slow the flow on the test strip.**

Unscrew the cap of provided assay buffer tube. Insert and mix the specimen swab into the tube. Stand for 1 min after thoroughly mixed.

Take the upper layer of mixture for testing **<Do not take the sediment from lower layer to prevent obstruction in the test strip.>**

Gradually drip 4 drops (100µL) of specimen into the sample well using disposable dropper. Interpret the result in 5-10 minutes.

Positive **Negative** **Invalid**

➤ ORDERING INFORMATION

Product Name	Cat. No.	Packaging	Shelf Life
Giardia Ag test	RE03-0	5 Tests/Kit	24 months
	RE03-1	10 Tests/Kit	



Peritonitis

Peritonitis Detection Kit

Feline infectious peritonitis (FIP) is a fatal immune-mediated disease triggered by infection with a feline coronavirus. It causes vasculitis and/or granulomatous changes. Leading to ascites and CNS change. Peritonitis Detection Kit can differentiate a transudate from an exudate. It is fast, simple and reliable to detect or exclude a peritonitis infection in cats.

➤ PRODUCT INTRODUCTION

Methodology	Rivalta test
Target	Protein, fibrinogen and inflammatory mediators in effusions.



➤ KIT COMPONENTS

COMPONENTS	5 TESTS/KIT	10 TESTS/KIT
Reaction tubes(containing acetic acid solution)	10	10
Dye-containing tubes	10	10
Droppers	10	10
instruction manual	1	10

➤ TEST PROCEDURE AND INTERPRETATION

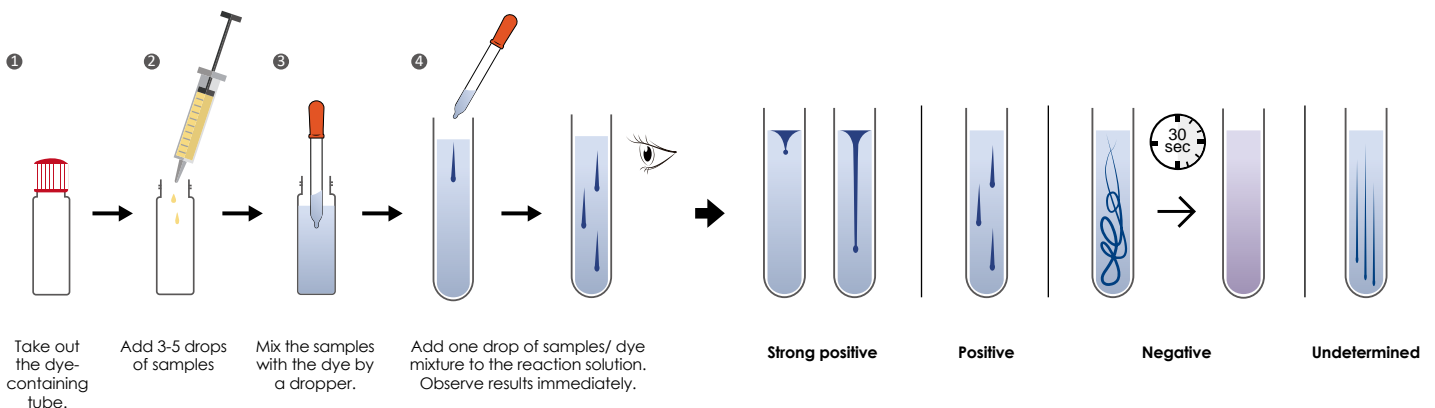

Ⓞ **Positive** : results need cytology and count cells of exudate to rule out bacterial infection or lymphosarcoma.

➤ ORDERING INFORMATION

Product Name	Cat. No.	Packaging	Shelf Life
Peritonitis Detection Kit	PDK-1	10 Tests/Kit	24 months



Feline Blood Typing Kit

Cat blood groups are classified using the A, B, AB blood type system. This blood typing system defines three blood types based on the presence of specific inherited antigens at the surface of the red blood cells. This typing kit uses antigen-antibody interaction to detect the cat's blood types via observing the agglutination in reaction wells. The operation is simple, and results can be interpreted within 5 minutes.

➤ PRODUCT INTRODUCTION

Methodology	Agglutination
Target	Surface Ag on red blood cells

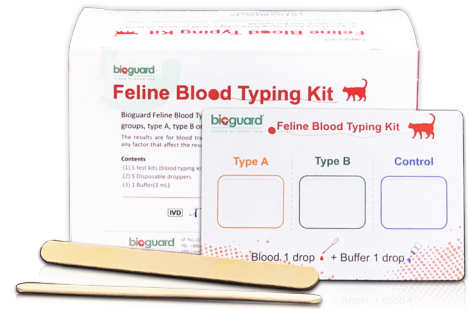

➤ KIT COMPONENTS

COMPONENTS	5 TESTS/KIT	10 TESTS/KIT
Plastic pouches, each containing blood typing kit, sticks and desiccant	5	10
Disposable dropper	5	10
Buffer(3 mL)	1	2
Blood typing card	5	10
Instruction manual	1	1

➤ TEST PROCEDURE AND INTERPRETATION

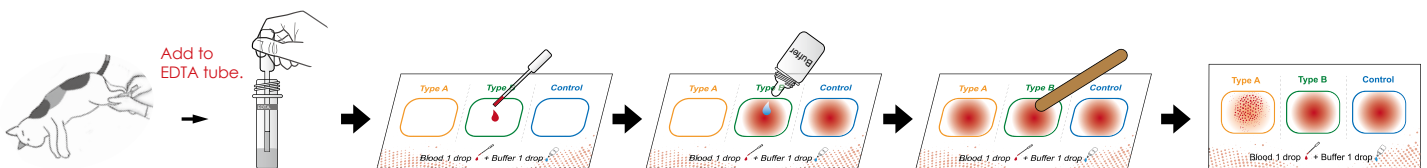

Collect 0.5 mL of blood. (Use tube with EDTA or anti-coagulants)

Put one drop of blood (20-30 µL) into each well of blood card

Put one drop of buffer (20-30µL) into each well

Mix with stick for 15 seconds (Use different stick in each well)

Examine agglutination within 2 mins

Type A	Type B	Type AB	False(+)
<div style="display: flex; justify-content: space-around;"> <div style="border: 1px solid orange; border-radius: 10px; padding: 5px; text-align: center;">Type A</div> <div style="border: 1px solid green; border-radius: 10px; padding: 5px; text-align: center;">Type B</div> <div style="border: 1px solid blue; border-radius: 10px; padding: 5px; text-align: center;">Control</div> </div> <p style="text-align: center;">Agglutination in well A</p>	<div style="display: flex; justify-content: space-around;"> <div style="border: 1px solid orange; border-radius: 10px; padding: 5px; text-align: center;">Type A</div> <div style="border: 1px solid green; border-radius: 10px; padding: 5px; text-align: center;">Type B</div> <div style="border: 1px solid blue; border-radius: 10px; padding: 5px; text-align: center;">Control</div> </div> <p style="text-align: center;">Agglutination in well A</p>	<div style="display: flex; justify-content: space-around;"> <div style="border: 1px solid orange; border-radius: 10px; padding: 5px; text-align: center;">Type A</div> <div style="border: 1px solid green; border-radius: 10px; padding: 5px; text-align: center;">Type B</div> <div style="border: 1px solid blue; border-radius: 10px; padding: 5px; text-align: center;">Control</div> </div> <p style="text-align: center;">Agglutination in well A and B</p>	<div style="display: flex; justify-content: space-around;"> <div style="border: 1px solid orange; border-radius: 10px; padding: 5px; text-align: center;">Type A</div> <div style="border: 1px solid green; border-radius: 10px; padding: 5px; text-align: center;">Type B</div> <div style="border: 1px solid blue; border-radius: 10px; padding: 5px; text-align: center;">Control</div> </div> <p style="text-align: center;">Agglutination in well control</p>

➤ ORDERING INFORMATION

Product Name	Cat. No.	Packaging	Shelf Life
Feline Blood Typing Kit	FBT-0	5 Tests/Kit	12 months
	FBT-1	10 Tests/Kit	

ORDERING INFORMATION

Canine Rapid Test

Product	Description	Specimen	Sensitivity(%)	Specificity(%)	Kit	Cat. No.
CPV Ag Test	Canine Parvovirus Antigen Test	Feces	95.74	100	5 test	RC01-0
					10 test	RC01-1
CCV Ag Test	Canine Coronavirus Antigen Test	Feces	93.10	97.52	5 test	RC02-0
					10 test	RC02-1
CDV Ag Test	Canine Distemper Virus Antigen Test	Ocular/nasal discharge	100	98.08	5 test	RC03-0
					10 test	RC03-1
CAV Ag Test	Canine Adenovirus Antigen Test	Ocular/nasal discharge	88.88	95.35	5 test	RC04-0
					10 test	RC04-1
CIV Ag Test	Canine Influenza Virus Antigen Test	Ocular/nasal discharge	90.0	100	5 test	RC05-0
					10 test	RC05-1
CHW Ag Test	Canine Heartworm Antigen Test	Whole blood, serum, plasma	99.03	100	5 test	RC06-0
					10 test	RC06-1
E. canis Ab Test	Ehrlichia Canis Antibody Test	Whole blood, serum, plasma	93.55	96.86	5 test	RC07-0
					10 test	RC07-1
Anaplasma Ab Test	Anaplasma Antibody Test	Whole blood, serum, plasma	94.59	98.98	5 test	RC08-0
					10 test	RC08-1
Lyme Ab Test	Borrelia burgdorferi (Lyme) Antibody Test	Whole blood, serum, plasma	95.00	96.67	5 test	RC09-0
					10 test	RC09-1
Leishmania Ab Test	Leishmania Antibody Test	Whole blood, serum, plasma	95.83	93.07	5 test	RC10-0
					10 test	RC10-1
Canine Babesia gibsoni Ab Test	Babesia gibsoni Antibody Test	Whole blood, serum, plasma	92.13	94.59	5 test	RC11-0
					10 test	RC11-1
Canine Babesia spp. Ab Test	Babesia spp. Antibody Test	Whole blood, serum, plasma	95.05	92.24	5 test	RC12-0
					10 test	RC12-1
Giardia Ag Test	Giardia Antigen Test	Feces	100	95.24	5 test	RC13-0
					10 test	RC13-1
CPV Ag/CCV Ag Combo Test	CPV Ag /CCV Ag Combo Test	Feces	95.74 /93.10	100 /97.52	5 test	RC14-0
					10 test	RC14-1
ANA Ab/E.canis Ab Combo Test	Anaplasma Ab/E.canis Ab Combo Test	Whole blood, serum, plasma	94.59 /93.56	98.98 /96.86	5 test	RC15-0
					10 test	RC15-1
VLabs 3DX	CPV Ag /CCV Ag / Giardia Ag Test	Feces	95.74 /93.10 /100	100 /97.52 /95.24	5 test	RC16-0
					10 test	RC16-1
VLabs 3RX	CDV Ag /CAV Ag /CIV Ag Test	Ocular/nasal discharge	100 /88.88 /90.0	98.08 /95.35 /100	5 test	RC17-0
					10 test	RC17-1
VLabs 4X	E. canis Ab /Anaplasma Ab/ Lyme Ab/ CHW Ag Test	Whole blood, serum, plasma	93.55 /94.59 /95.00 /99.03	96.86 /98.98 /96.67 /100	5 test	RC18-0
					10 test	RC18-1
VLabs 4BX	E. canis Ab /Anaplasma Ab/ B. gibsoni Ab/ CHW Ag Test	Whole blood, serum, plasma	93.55 /94.59 /92.13 /99.03	96.86 / 98.98 / 94.59 / 100	5 test	RC19-0
					10 test	RC19-1
VLabs 4BX Plus	E. canis Ab /Anaplasma Ab/ Babesia Ab/ CHW Ag Combo Test	Whole blood, serum, plasma	93.55 /94.59 /95.05 /99.03	96.86 /98.98 /92.24 /100	5 test	RC20-0
					10 test	RC20-1
VLabs 4LX	E. canis Ab /Anaplasma Ab/ Leishmania Ab/ CHW Ag Test	Whole blood, serum, plasma	93.55 /94.59 /95.83 /99.03	96.86 /98.98 /93.07 /100	5 test	RC21-0
					10 test	RC21-1

ORDERING INFORMATION

Feline Rapid Test

Product	Description	Specimen	Sensitivity(%)	Specificity(%)	Kit	Cat. No.
FIV Ab Test	Feline Immunodeficiency Virus Antibody Test	Whole blood, serum, plasma	97.50	96.67	5 test	RF01-0
					10 test	RF01-1
FeLV Ag Test	Feline Leukemia Virus Antigen Test	Whole blood, serum, plasma	98.04	98.70	5 test	RF02-0
					10 test	RF02-1
FPV Ag Test	Feline Parvovirus Antigen Test	Feces	92.54	97.09	5 test	RF03-0
					10 test	RF03-1
Toxoplasma IgM/ IgG Ab Test	Toxoplasma IgM / IgG Antibody Test	Whole blood, serum, plasma	92.59	94.37	5 test	RF04-0
					10 test	RF04-1
FCoV Ab Test	Feline Coronavirus Antibody Test	Pleural /abdominal effusion, serum, plasma	88.57	94.23	5 test	RF05-0
					10 test	RF05-1
FCoV Ag Test	Feline Coronavirus Antigen Test	Feces	96.67	100	5 test	RF06-0
					10 test	RF06-1
FHV Ag Test	Feline Herpes Virus Antigen Test	Ocular/nasal discharge	97.0	100	5 test	RF08-0
					10 test	RF08-1
FCV Ag Test	Feline Calicivirus Antigen Test	Ocular/nasal discharge	97.0	100	5 test	RF09-0
					10 test	RF09-1
FCV Ag/FHV Ag Combo Test	FCV Ag / FHV Ag Combo Test	Ocular/nasal discharge	97.0 /97.0	100 /100	5 test	RF10-0
					10 test	RF10-1
FeLV Ag/FIV Ab Combo Test	FeLV Ag / FIV Ab Combo Test	Whole blood, serum, plasma	98.04 /97.50	98.70 /96.67	5 test	RF11-0
					10 test	RF11-1
Feline 3X	FeLV Ag / FIV Ab / FCoV Ab Test	Whole blood, serum, plasma (FeLV /FIV)	98.04 /97.50	98.70 /96.67	5 test	RF12-0
		Whole blood, serum, plasma, pleural / abdominal effusion (FCoV)			/88.57	/94.23
Feline 3DX	FPV Ag / FCoV Ag / Giardia Antigen Test	Feces	92.54 /96.67	97.09 /100	5 test	RF13-0
			/100		/95.24	10 test

Exotics Rapid Test

Product	Description	Specimen	Sensitivity(%)	Specificity(%)	Kit	Cat. No.
Salmonella spp. Ag Test	Salmonella spp. Antigen Test	feces	95.05	99.00	5 test	RE01-0
					10 test	RE01-1
Candida albicans Ag Test	Candida albicans Antigen Test	Oral swab,	92.30	98.61	5 test	RE02-0
		feces			10 test	RE02-1
Giardia Ag Test	Giardia Antigen Test	Feces	100	95.24	5 test	RE03-0
					10 test	RE03-1

Other Products

Product	Description	Specimen	Kit	Cat. No.
Peritonitis Detection Kit	Peritonitis Detection Kit	Ascites, pleural effusion	10 test	PDK-1
Feline Blood Typing Kit	Feline Blood Typing Kit	Whole blood	5 test	FBT-0
			10 test	FBT-1

ORDERING INFORMATION

Upcoming Products

Product	Description	Kit	Cat. No.
Canine			
C. Brucella Ab Test	Brucella canis Antibody Test	5 test	RC22-0
		10 test	RC22-1
Rabies Ag Test	Rabies Virus Antigen Test	5 test	RC23-0
		10 test	RC23-1
Neospora caninum Ab Test	Neospora Antibody Test	5 test	RC24-0
		10 test	RC24-1
Relaxin Test	Relaxin Hormone Test	5 test	RC25-0
		10 test	RC25-1
Lepto Ab Test (Canine/Feline)	Leptospira Antibody Test	5 test	RC26-0
		10 test	RC26-1
Helicobacter pylori Ag Test (Canine/Feline)	Helicobacter pylori Antigen Test	5 test	RC27-0
		10 test	RC27-1
Feline			
Tritrichomonas foetus Ag Test	Tritrichomonas foetus (Feline) Ag	5 test	RF15-0
		10 test	RF15-1
Chlamydia felis Ag Test	Chlamydia felis Ag	5 test	RF16-0
		10 test	RF16-1
FHW Ag/Ab Test	Feline Heartworm Antigen/Antibody Combo Test	5 test	RF07-0
		10 test	RF07-1
Feline 3RX	FCV Ag/FHV Ag/ Chlamydia felis Ag Test	5 test	RF17-0
		10 test	RF17-1
Feline 3HX	FHW Ag / FeLV Ag / FIV Ab Test	5 test	RF14-0
		10 test	RF14-1
Feline 4DX	FPV Ag/FCoV Ag/Giardia Ag/Tritrichomonas foetus Ag Test	5 test	RF18-0
		10 test	RF18-1
Exotics-Avian			
Pacheco's Disease Test	Pacheco's Disease (Herpesvirus) Antigen Test	5 test	RE04-0
		10 test	RE04-1
Poxviruses Ag Test	Poxviruses Antigen Test	5 test	RE05-0
		10 test	RE05-1
Chlamydiophila psittaci Ag Test	Psittacosis (Chlamydiophila psittaci) Antigen Test	5 test	RE06-0
		10 test	RE06-1
Cryptococcus neoformans Ag Test	Cryptococcus neoformans Antigen Test	5 test	RE07-0
		10 test	RE07-1
Trichomonas gallinae Ag Test	Trichomonas gallinae Antigen Test	5 test	RE08-0
		10 test	RE08-1
Exotics-Rabbit			
Rotavirus Ag Test	Rotavirus Antigen Test	5 test	RE09-0
		10 test	RE09-1
Exotics-Reptile			
Salmonella spp. Ag Test	Salmonella spp. Antigen Test	5 test	RE10-0
		10 test	RE10-1
Lepto Ab Test	Leptospira Antibody Test	5 test	RE11-0
		10 test	RE11-1
Herpes Virus Ag Test	Herpes Virus Antigen Test	5 test	RE12-0
		10 test	RE12-1
Campylobacteria Ag Test	Campylobacteriosis	5 test	RE13-0
		10 test	RE13-1

USER GUIDE FOR THE BIOGUARD CANINE/ FELINE RAPID TEST KITS

Question & Answer

I. Preparation and Collection of Samples

Q1 What's the difference between whole blood, plasma and serum?

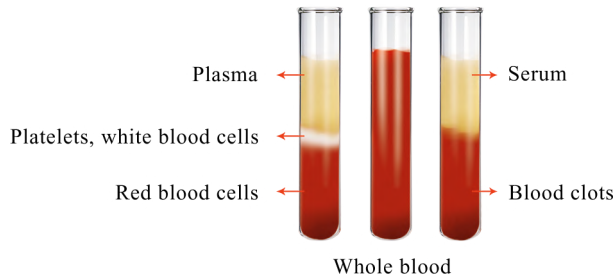

A Whole blood: When the blood is collected into a tube that contains anti-coagulants and mixed with anti-coagulants. Whole blood contains blood cells and plasma.

Plasma: When the mixture of anti-coagulants and whole blood are centrifuged, the yellow upper layer without blood cells is the plasma.

Serum: The blood is collected into a tube without anti-coagulants and allowed to clot. After centrifuging, the serum is the yellow upper layer that separates from the clotted blood.

Q2 How to collect and preserve samples of feces?

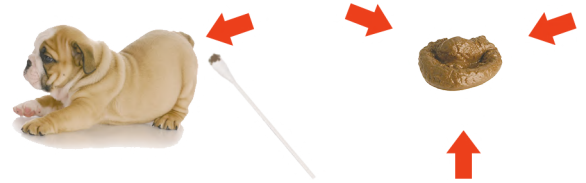

A Use sterile swabs to collect feces from the dog's anus or from at least three different places on the feces. Combine these feces in the sample buffer.

Feces should be tested as soon as they are collected. Feces can be preserved for about 12 hours at room temperature and about 24 hours at 2-8°C.

DO NOT use feces that are not preserved properly.

Q3 How to collect the ocular secretion?



A Use sterile swabs to collect the ocular secretion from the conjunctiva. It can be helpful to wet sterile swabs with saline water before collection.

Q4 How to collect the nasal secretion?



A Use sterile swabs to collect the nasal secretion from the nasal cavity.

It can be helpful to wet sterile swabs with saline water before collection.

Q5 What's the minimum amount to collect for the ocular or nasal secretions? Could I combine them together?

A Make sure that sterile swabs are covered by the ocular or nasal secretions as much as possible. We recommend that samples from different body parts should be tested separately. However, if there are not enough samples, the ocular and nasal secretions can be tested together.

II. Testing Procedure

Q1 Do rapid test kits need to be stored in the refrigerator or in the freezer?

A Please store rapid test kits in a dry place at room temperature. Avoid direct sunlight. If it is stored in the refrigerator, let it return to room temperature before using it. Please DO NOT FREEZE.

Q2 Why doesn't the sample solution flow through the test strips properly?

A After putting sterile swabs with samples in the buffer, let large particles precipitate for 1 minute. Then, only use the upper layer on the test strips to prevent the aggregation. For whole blood samples, if the sample solution does not flow properly, add 1-2 more drops of the buffer.

Q3 Is it ok to mix buffers or use different buffers from different kits?

A No. Please only use the buffer within the kits. Results can't be guaranteed if the buffers from different lot numbers are used in the test.

Q4 Could I change the amount of the buffer being added?

A Please follow the instructions, add only 2-3 drops of the buffer. Adding too much buffer might cause the sample solution to move too fast, and reduce the sensitivity of tests. If flow rate is too slow, add 1-2 more drops of the buffer to increase its speed.

III. Results Interpretation

Q1 Are results still valid after 15 minutes?

A The results are invalid. Results are ONLY valid within 10 minutes. After 10 minutes, false positive results might appear.

Q2 How do you interpret the results if the Test band is faint?

A If infected dogs/cats are latent or in the early stage of infection, the amount of viruses/antibodies might be lower in the samples. The T band might be faint in the first 3-5 minutes, but it will become clearer in 10 minutes. A faint band will still count as a positive result.

Q3 What should I do if results are different from clinical symptoms?

A The Bioguard Canine/ Feline Rapid Test Kits are for in vitro veterinary diagnosis only. Please consult all other clinical symptoms and use other diagnostic methods (i.e. PCR) to ensure an accurate diagnosis.

Q4 How to interpret results if the Test band appears in 10 minutes, but it disappears after that?

A This result is due to the high concentration of viruses in the samples. If this happens, please redo the test with diluted samples.

Q5 How to interpret results if the Control band appears in 10 minutes, but it disappears after that?

A This result is due to samples being contaminated with other antibodies. If this happens, please redo the test with fresh samples.

Q6 Is it ok that the colors of the Test band and the Control band are different?

A The color difference won't affect the interpretation of results. The Control band should appear during all tests to clarify a valid result, no matter its color is bright or dark.





bi+guardTM
science for animal care



6F, No. 20-1, Wu-kong 5th Rd., Wugu District, New Taipei City 248020, Taiwan
Tel:+886-2-5591-6688 | Fax:+886-2-6625-8182
E-mail: service@bioguard.com.tw | Web: www.bioguardlabs.com